



ATTACHING HANDLEBAR AND STEM

The handlebar and stem of your tricycle is shipped partially assembled for safer and more efficient packing. After unpacking your tricycle, follow these steps to safely attach the handlebar and stem. Please use the graph below to identify the components:

TOOLS NEEDED:

One 6mm allen wrench

1. Untie the handlebar and make sure that the stem, stem wedge bolt (1), and stem wedge nut or lug nut (3) are present.
2. If the wedge bolt is tight, loosen the bolt using a 6mm allen wrench.
3. Insert the stem into the frame's steering tube until the "minimum insertion mark" is no longer visible (2).
4. While holding the handlebar, tighten the stem wedge bolt (1). Rotate the handlebar to make sure that it is square with the fork.
5. Once the stem wedge bolt is tightened, adjust the angle of the handlebar to desired upright position. To do that, loosen handlebar binder bolt with a 6mm allen wrench and tighten it when the handlebar is at the right position.
6. Test the tightness of the stem by straddling the front wheel, while holding the wheel with your feet, try to steer to right and left (4). You should feel resistance and handlebar should not rotate inside the steering tube.

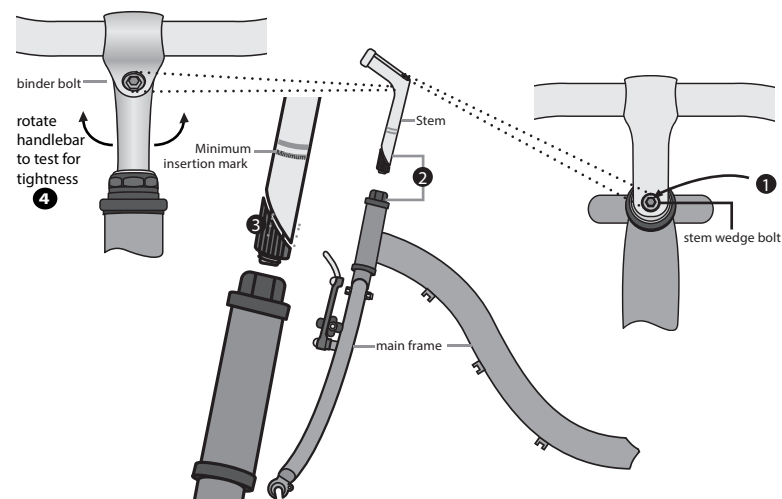

For questions and assistance, please call us at (800) 392-3337.